

SERVICE LOCATION RECORD CARD

| K | LOC | ACCT | SUB | WORK ORDER NO | CITY NO | KEY NO. | GRID NO | CP NO | PROJECT NO |
|---|-----|--------|-------|---------------|---------|---------|---------|-------|------------|
| 3 | 177 | 20,280 | 0.311 | 183969 | 700 | 65 | AN-26 | | 000311 |

PLSR

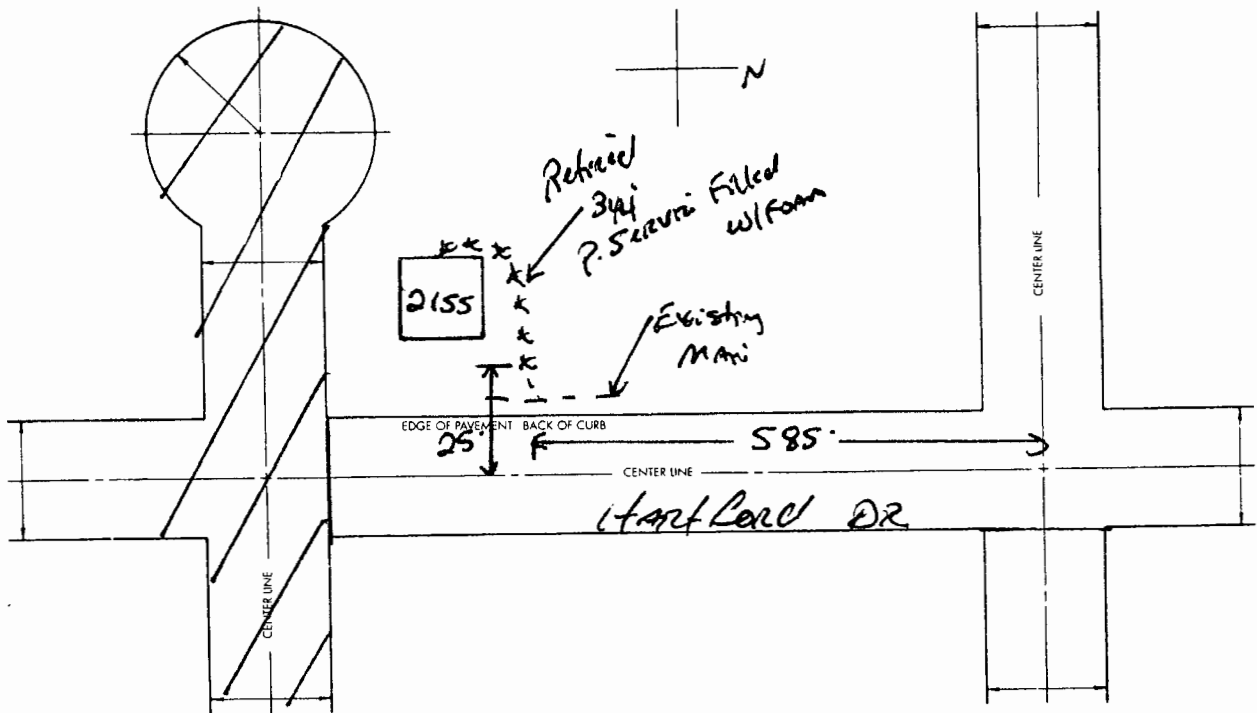

LOCATION 2155 Hartford Dr CITY Easton

BETWEEN _____ STREET & _____ STREET

| | SIZE | TYPE | LENGTH | INSTALLED | RETIRED | RENEWED |
|-------------------|-------------|-----------|-------------|-----------|----------------|---------|
| MAIN TO BLDG | <u>3/4"</u> | <u>P.</u> | <u>100'</u> | | <u>8-21-03</u> | |
| MAIN TO PROP LINE | | | | | | |
| PROP LINE TO BLDG | | | | | | |

ENTERS. 2155 BRANCHED INTO _____

TAP SIZE _____ PRESSURE _____ PSI _____ INCHES W.C. LOCATION 585' S. of center of Hartford Dr

PRESSURE TEST @ 100 PSI FOR _____ HRS BY S.L.K.

MAIN-SIZE _____ C I _____ BARE STEEL _____ COATED STEEL _____ PLASTIC / YEAR INSTALLED 1983

DEPTH 2 FT 0 IN LOCATION 25' W. of center of Hartford Dr

"A" P/S READING P TOTAL ANODES 1# 0 17# 0 LR # 487354

REMARKS _____

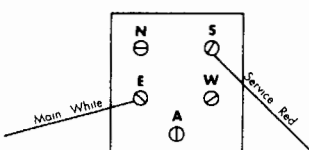

| Test Station | | |
|-----------------------------------------|----------|-------|
| Reading & Location | Lead | Volts |
| P/S Pipeline Lead - Red New Service | <u>S</u> | |
| P/S Pipeline Lead - White Existing Main | <u>E</u> | |